

ONLINE ETERNALIGHT MINI

SPECIFICATIONS

- The Online Eternalight Mini maintains efficient AC Emergency Power to operate all emergency lighting fixtures at "full-light" output, providing superior dependability and security to commercial/ industrial environments in a small footprint.

DIAGNOSTICS AND MAINTENANCE

- DSP/PWM technology and DSPM Watchdog Software provides complete self diagnostic capabilities and LED Monitoring
- Informative advanced Display and Alarms keep you in control of your emergency lighting environment 24/7
- Automatically performs periodic self-tests ensuring a safely lighted environment prior to an emergency
- Single point of testing instead of multiple testing points with battery packs

PROTECTION

- Provides overload, surge and undercurrent protection using DSP/PWM technology and DSPM Watchdog Software to protect system performance and reliability
- Surge protection against load surges as defined in ANSI/IEEE C62.45 category A and B

INPUT

- 120V, 208V, 240V, 277V or 480V input 60Hz

OUTPUT

- 120V, 240V, 277V, 480V, 120/240 or 120/277VAC.

True "on-line" design is $\geq 92\%$ efficient at 100% linear load

BATTERIES

- Sealed, maintenance-free, lead calcium (AGM) batteries
- 10-Year prorated warranty
- DSP/PWM Smart Battery Monitoring System is TEMPERATURE COMPENSATED maintaining maximum runtime and battery life
- Microprocessor controlled recharge and DSP/PWM overcharge protection standard

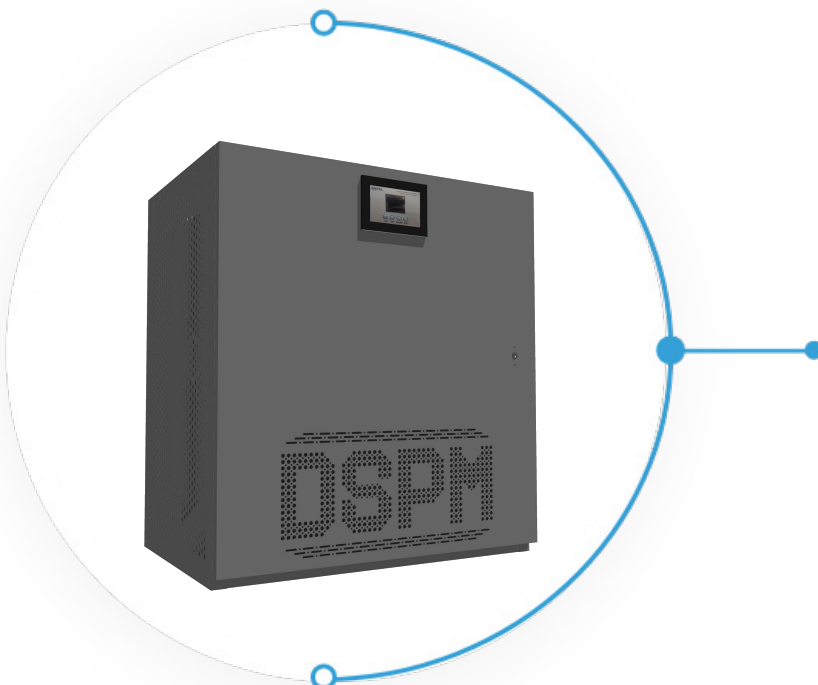

350 W - 2000 W

Single Phase

Uninterrupted

Emergency

Lighting and

Power

Systems

LAMPS AND LOADS

- Emergency power provides FULL LIGHT OUTPUT from all lamps and fixtures for the entire runtime
- Operates fluorescent, compact fluorescent, incandescent, quartz, H.I.D., LED and other lamp types
- Standard or electronic ballasts, dimming devices or panels, sensors and most control equipment
- Standard or LED Exits and other safety equipment

CODES

- UL 924, UL1778, meets NFPA 101, NFPA 70, NEC and OSHA standards
- Cities of Chicago and New York approved
- Complies with the Buy American Act

WARRANTY

- 1-Year full warranty on system electronics
- Battery warranty 1-year with 9-years pro-rated
- System 1-year on-site warranty labor with DSPM phone assisted start-up
- 5-Year powertrain warranty
- Maintenance contracts available

INSTALLATION

- Modular design and small footprint allow easy installation in electrical closet or other convenient locations
- Phone assisted factory start-up standard for all systems
- Extended warranty available

SPECIAL APPLICATIONS

- DSPM offers numerous UL924 optional devices to meet unusual or difficult application parameters
- ECM - Environmental Circuit Module allows fixtures and lamps on the emergency circuit(s) to be operated by normal switching and/or dimming devices in NON-emergency conditions
- Dimming Panel Interface allows use with emergency lights controlled by common dimmer panel

CABINET

- Space saving small footprint
- Modular design enables flexible installation
- NEMA 1 rated

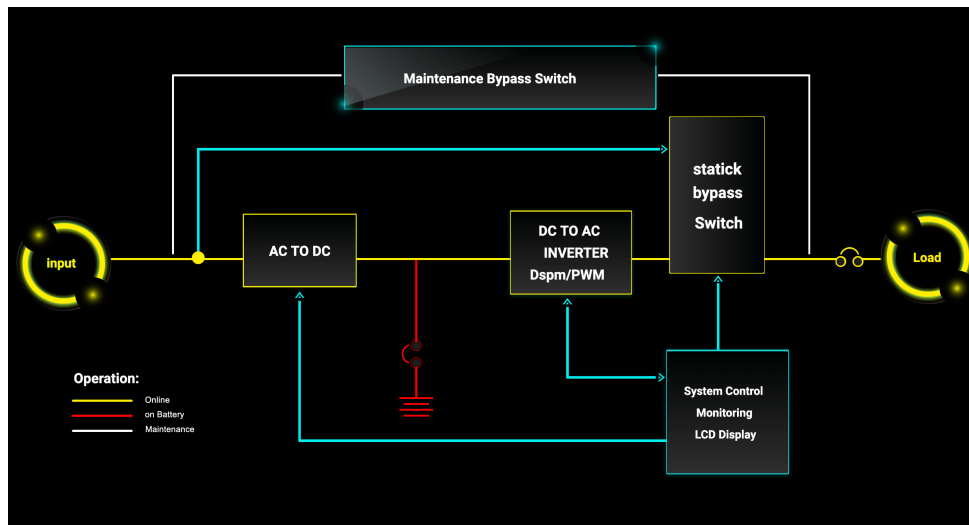

ELECTRICAL SPECIFICATIONS

Input Voltage Range	+10% , -15%
Output Voltage Regulation	±2% for all loads and battery discharge mode
Output Frequency Range	60 Hz, ±1%
Output Wave Form	Sine-wave <5% @ 100% linear load
Crest Factor	2.5:1 typical
Input Protection	Input Main Circuit Breaker
Output Protection	Output Main Circuit Breaker
Surge Protection	The unit will protect itself and the load against surges as defined in ANSI/IEEE C62.45 category A and B
Efficiency	≥92% at 100% linear load
Audible Noise	<45dB measured on Response Curve "A"
Operating Temperature	0° to 40°C (32° to 104°F)
Storage Temperature	-20° to 60°C (-4° to 140°F)
Humidity	5 - 95%, Non-condensing

Mini Series	Power Ratings	UPS			Weight	British Thermal Unit	Battery Type	Voltage (VAC)		Output Protection	Safety Approvals
		Cabinet Dimensions						Input	Output		
OEMINI	VA/W	W	H	D	(lbs)	BTU's	Sealed, Maintenance free (AGM) lead calcium	Select 120, 208, 240, 277 or 480	Select 120, 277, 480, 120/240 or 120/277	Input and output circuit breakers standard	UL924 UL1778 NFPA 101 NFPA 70 NEC
	350	24"	26"	16"	340	95.2					
	525	24"	26"	16"	340	142.8					
	700	24"	26"	16"	370	190.4					
	750	24"	26"	16"	370	204					
	875	24"	26"	16"	370	238					
	1050	24"	26"	16"	440	285.6					
	1400	24"	26"	16"	460	380.8					
2000	24"	26"	16"	600	544						

The Online Eternalight Mini provides the simplicity and reliability that is critical when providing an alternative source of power to any environment. Easy installation..."simplicity"...connect the Mini to the emergency circuit(s) and everything is backed up..."reliability"...during a power outage. All lighting connected to the Mini will simply continue to operate at "full light output". DSPM Watchdog© software keeps your environment safe while self-diagnostics help maintain equipment to a high standard. Superior surge suppression assures the highest quality of power being delivered to all loads, all the time. Equipment and lamp life are maximized.

We sincerely hope you never experience a real emergency, but if you do, you deserve the security, safety and peace of mind that the Defender Mini from DSPM ensures.

ORDERING INFORMATION

Choose the bold face catalog nomenclature that best suites your needs.

Write them on the appropriate line. Order accessories as separate catalog number.

Example:

OEMINI - 1050 - 208/120 - OCB/120/3/20/1 NOF/120/1 - 90

Description of example:

(1050 Watt, 208 Voltage In, 120 Voltage Out, 3 Output 120 Voltage Circuit Breakers at 20amps, 2 pole, 1 Normally Off 120 Volt Output Circuit, 90 minute run time)

OEMINI

FAMILY	POWER RATING	VOLTAGE ¹		OPTIONS	TIME ³
	<u>V/W</u>	<u>Input/Output</u>	<u>Input/Output</u>	<u>ECM120 - 120V Environmental control module²/qty</u>	<u>Minutes</u>
	350	120/120	240/120-240	<u>ECM277 - 277V Environmental control module²/qty</u>	5
	525	120/277	240/120-277	<u>NOF - Normally OFF output circuit/voltage / qty/pole</u>	10
	700	120/480	277/120	<u>NOH - Normally OFF "Hold ON"/voltage/qty/pole</u>	15
	750	120/120-240	277/277	<u>OCB - Output circuit breakers /voltage /quantity/amps/pole</u>	20
	875	120/120-277	277/480	<u>EPO - Emergency power off</u>	25
	1050	208/120	277/120-240	<u>RSSP - Remote Indicator Panel</u>	30
	1400	208/277	277/120-277	<u>SNMP - SNMP Card</u>	45
	2000	208/480	480/120	<u>FC - Form C Contacts</u>	60
		208/120-240	480/277	<u>SRB - Seismic rated bracket</u>	90 (Standard)
		208/120-277	480/480	<u>WB - Wall mounted bracket</u>	120
		240/120	480/120-240	<u>STUM - Onsite start-up</u>	180
		240/277	480/120-277	<u>IDB - Internal dimmer bypass</u>	240
		240/480		<u>EMB - External maintenance bypass switch</u>	
				<u>EW - Extended warranty</u>	

NOTES:

1- Consult factory for other voltage requirements.

Special voltages may effect the weight, size and number of cabinets.

2- One ECM is used per switching device or circuit.

3- Consult factory for other run times. Specifications subject to change without notice.

MECHANICAL FOOTPRINT

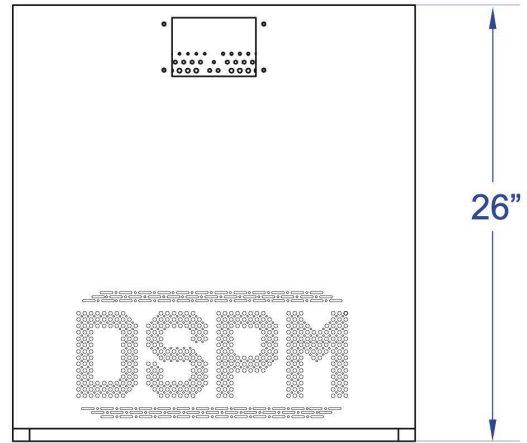
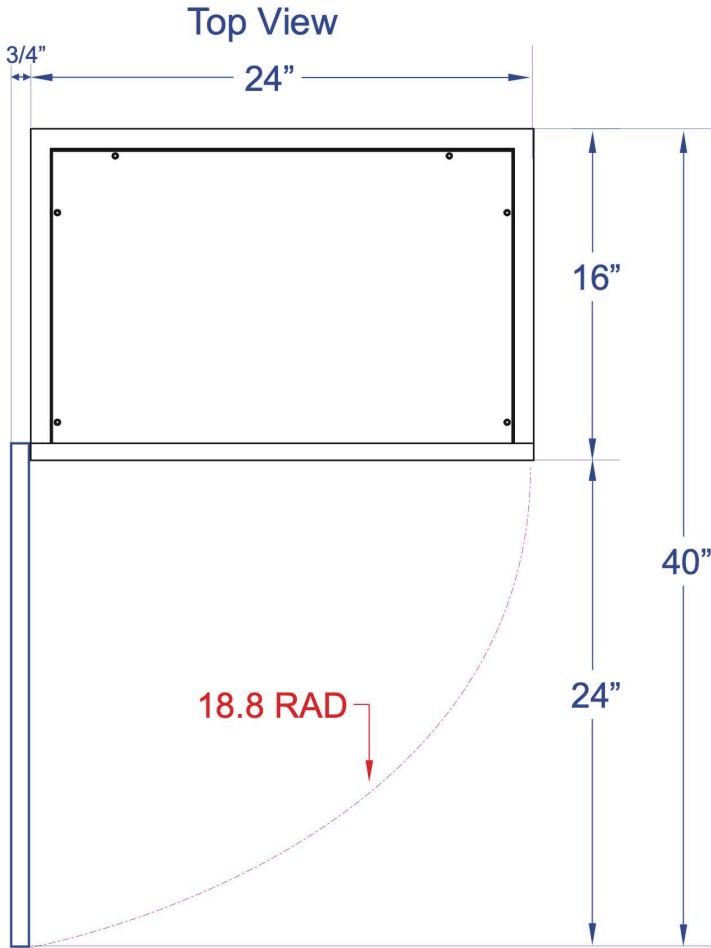

Front View

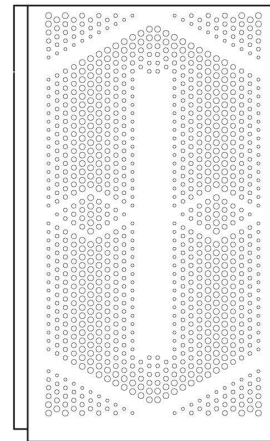

Right Side View

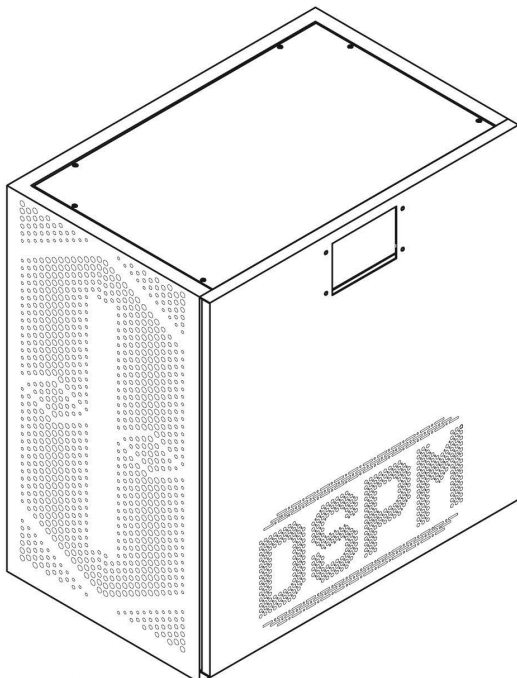

Per code requirements please leave 3" on each side of the cabinet including the back, and a 3 foot clearance in front.

Notice: This drawing contains confidential and proprietary data originated. All design, manufacturing, reproduction, use and sale rights are expressly reserved. The recipient agrees by accepting this document, not to supply or disclose and information regarding it to any unauthorized person, or to incorporate this data into any other design or use thereof. All patent rights are expressly reserved.